

DETOUR LENGTH: 10.2 miles

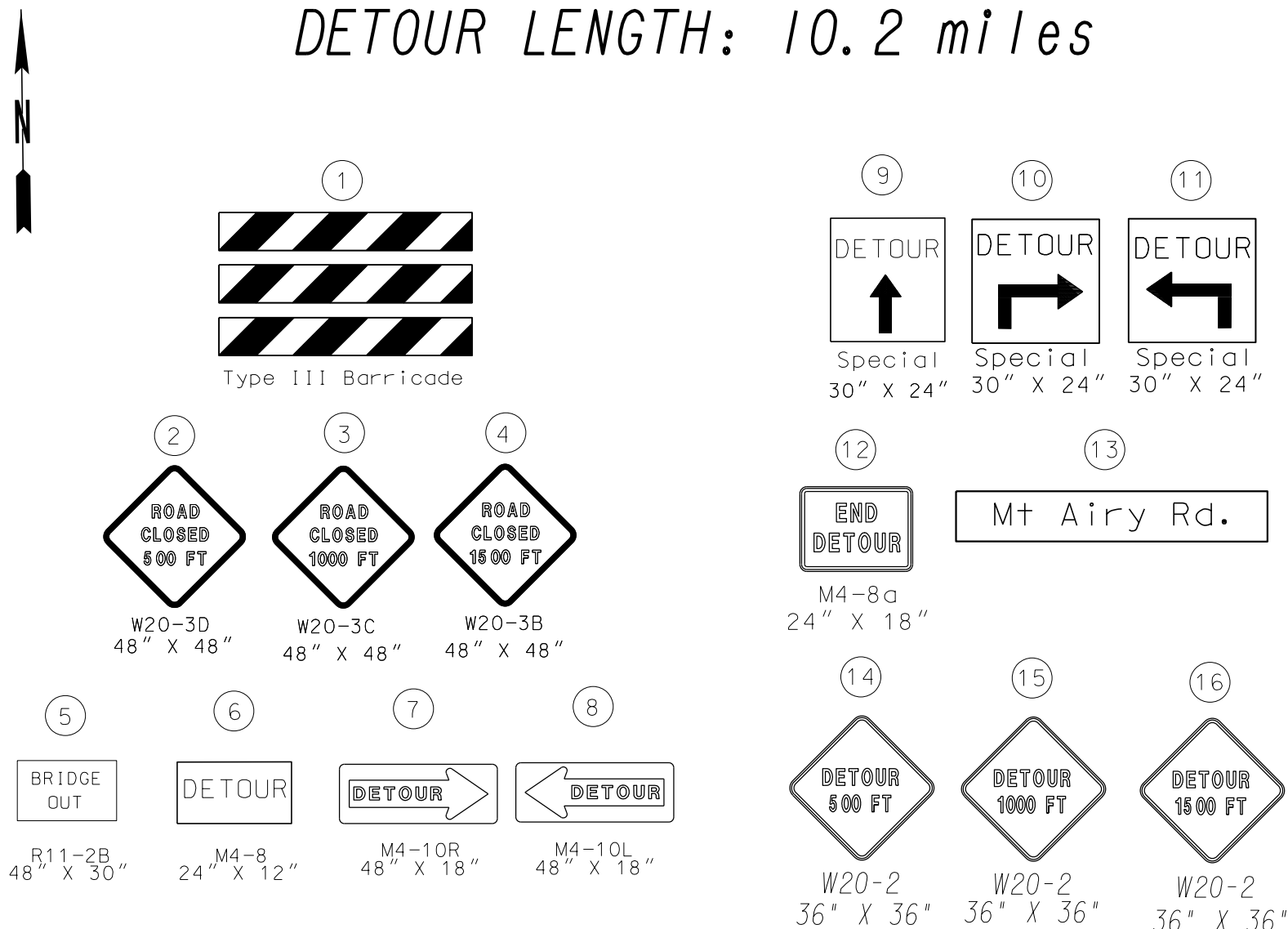

NOTE: SIGNS SHALL BE LOCATED AT THE DISCRETION OF THE FIELD ENGINEER.

DETOUR SIGNING/MAINTENANCE WILL BE PAID AS PART OF LUMP SUM TRAFFIC CONTROL.

DETOUR LENGTH: 10.20 MILES
 DETOUR LENGTH ALONG SR 85: 1.38 MI
 DETOUR LENGTH ALONG MT. AIRY RD: 4.04 MI
 DETOUR LENGTH ALONG RIDGEWAY RD: 4.39 MI
 DETOUR LENGTH ALONG TALBOTTON RD: 0.39 MI

LEGEND

| | |
|---------------------------------|-------------|
| DETOUR CENTERLINE | ————— |
| NON-DETOUR CENTERLINE | - - - - - |
| INSET BOUNDARY (SHEET 20-0001B) | - · - · - · |

LEGEND

| | |
|---|------------------------|
| ↓ | DETOUR ROUTE (INGRESS) |
| ↑ | DETOUR ROUTE (EGRESS) |



NOT TO SCALE

REVISION DATES

| | | |
|--|--|--|
| | | |
| | | |
| | | |
| | | |
| | | |
| | | |
| | | |
| | | |

STAGING DETAILS
CR 196 MT. AIRY ROAD
BRIDGE REPLACEMENT

| | | |
|--------------|-------|-------------|
| CHECKED: | DATE: | DRAWING No. |
| BACKCHECKED: | DATE: | 20-0001 |
| CORRECTED: | DATE: | |
| VERIFIED: | DATE: | |